

Official Zoning Map

Map prepared by Worcester County Department of Development Review and Permitting, November 3, 2009.
 Source: Worcester County Commissioners; UPDATE 5/14/19 described as: NOTE: The properties shown on Tax Map 63 as Parcels 3, 4, 5, 20, 21, 25, 67, 88, 89, 90, 91, 94, 102, 106, 107, 144, 153, 161, 171, 177 and 183, on Tax Map 71 as Parcels 1 and 49, and on Tax Map 201 as Parcel 1708 were de-annexed by the Town of Snow Hill on May 14, 2019 by Resolution No. 2019-01. Upon this de-annexation the properties were placed in the zoning district classifications they held under Worcester County's jurisdiction at the time they were originally annexed by Resolution 2005-5 on December 13, 2005 and effective on January 27, 2006.

Tax Map 71

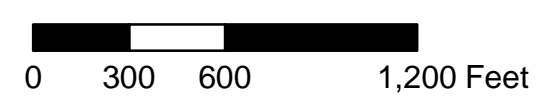
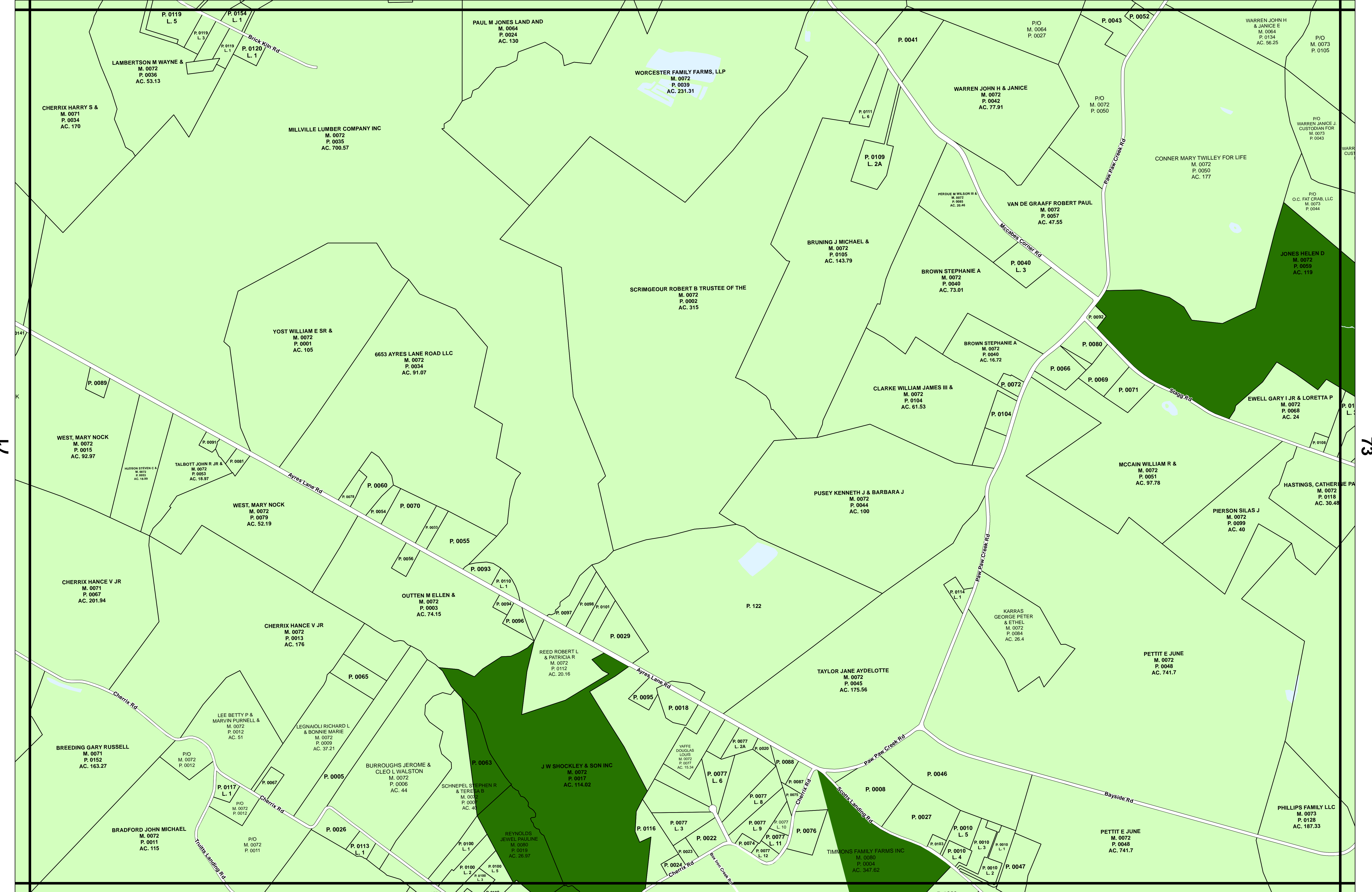

Official Zoning Map

Map prepared by Worcester County Department of Development Review and Permitting, November 3, 2009.
 Source: Worcester County Commissioners.

	A1		RP		R2		I1		C1		V1
	A2		E1		R3		I2		C2		MUN
	CA		R1		R4		CM		C3		

Tax Map 72

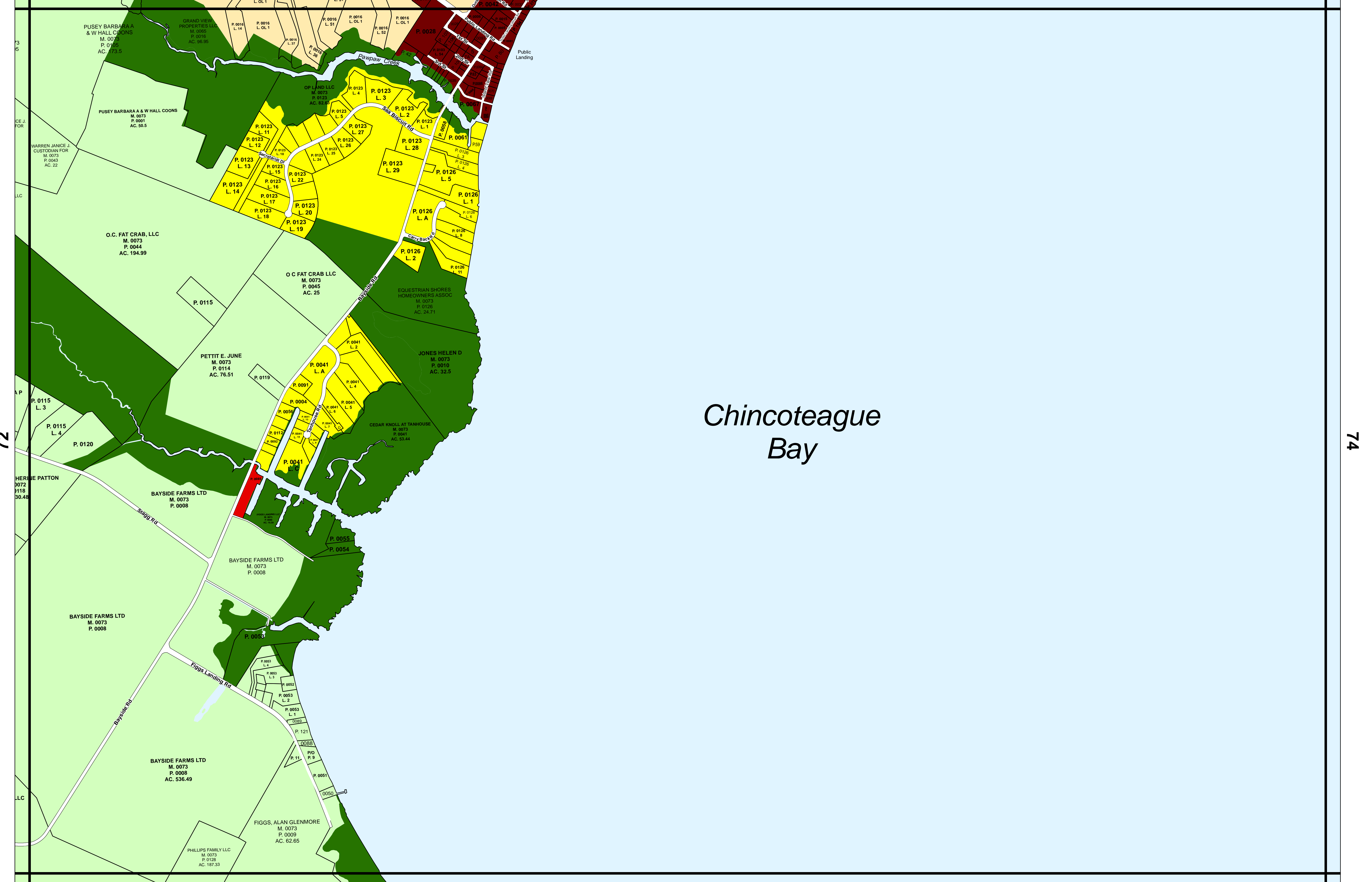

Chincoteague Bay

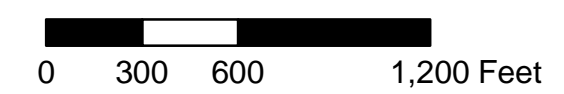

Official Zoning Map

Map prepared by Worcester County Department of Development Review and Permitting, November 3, 2009.
 Source: Worcester County Commissioners.

A1	RP	R2	I1	C1	V1
A2	E1	R3	I2	C2	MUN
CA	R1	R4	CM	C3	

Tax Map 73

65

66

67

73

75

Chincoteague Bay

UNITED STATES OF AMERICA
N. 0055
P. 0000
AC. 6411

UNITED STATES OF AMERICA
N. 0055
P. 0000
AC. 6411

81

82

0 300 600 1,200 Feet

Official Zoning Map

Map prepared by Worcester County Department of Development Review and Permitting, November 3, 2009.
Source: Worcester County Commissioners.

 A1	 RP	 R2	 I1	 C1	 V1
 A2	 E1	 R3	 I2	 C2	 MUN
 CA	 R1	 R4	 CM	 C3	

Tax Map 74

66

67

74

82

STATES OF AMERICA
0000
6411

Assateague Island

Atlantic Ocean

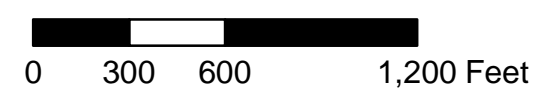

Official Zoning Map

Map prepared by Worcester County Department of Development Review and Permitting, November 3, 2009.
Source: Worcester County Commissioners.

 A1	 RP	 R2	 I1	 C1	 V1
 A2	 E1	 R3	 I2	 C2	 MUN
 CA	 R1	 R4	 CM	 C3	

Tax Map 75

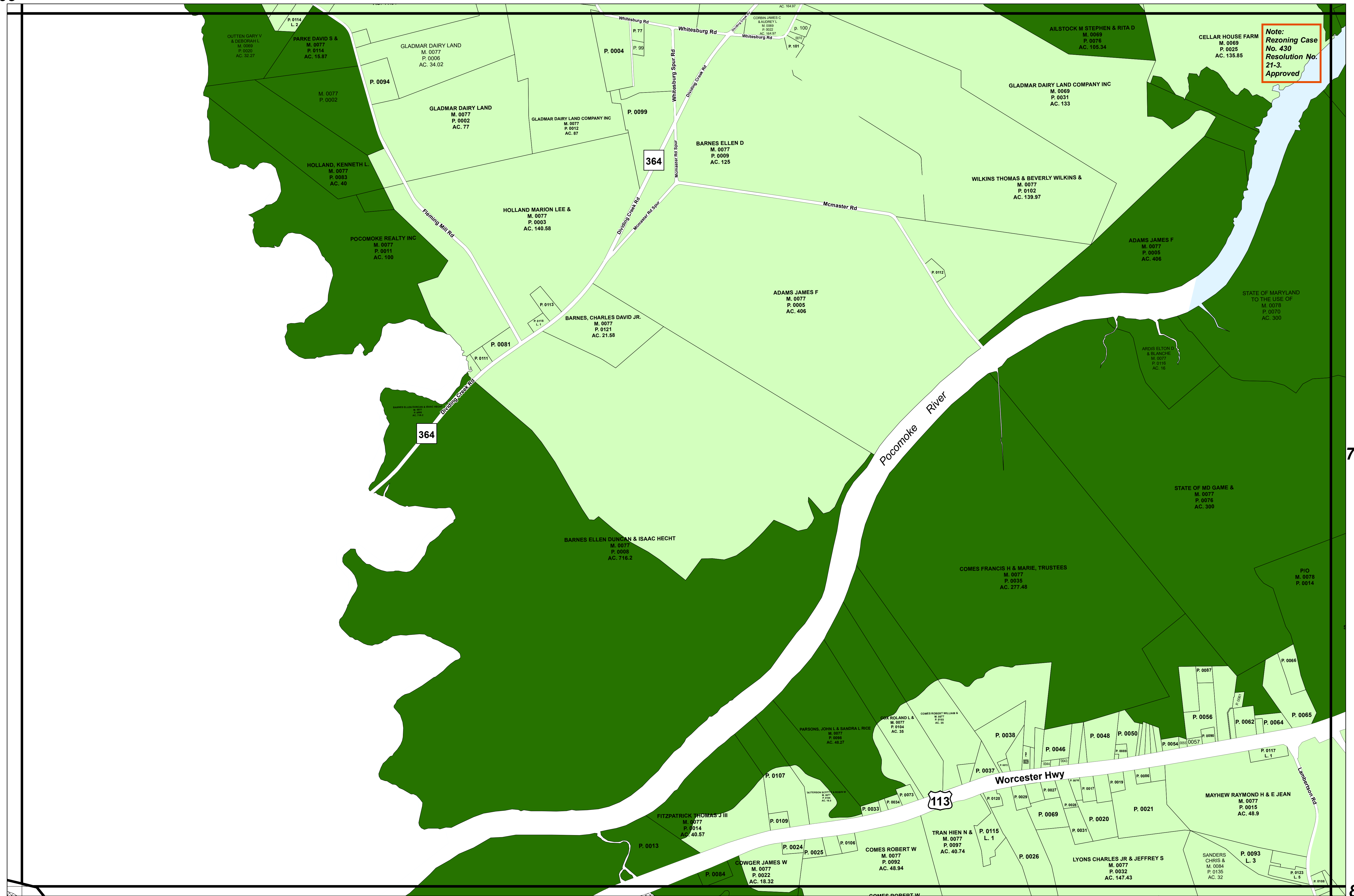

400P 0 300 600 1,200 Feet

Official Zoning Map

A1	RP	R2	I1	C1	V1
A2	E1	R3	I2	C2	MUN
CA	R1	R4	CM	C3	

Map prepared by Worcester County Department of Development Review and Permitting, November 3, 2009.
 Source: Worcester County Commissioners.
 Updated: Resolution No. 21 - 3, Effective 06/01/21, Case No. 430.

Tax Map 77

Note:
Rezoning Case
No. 430
Resolution No.
21-3.
Approved

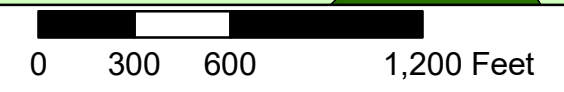
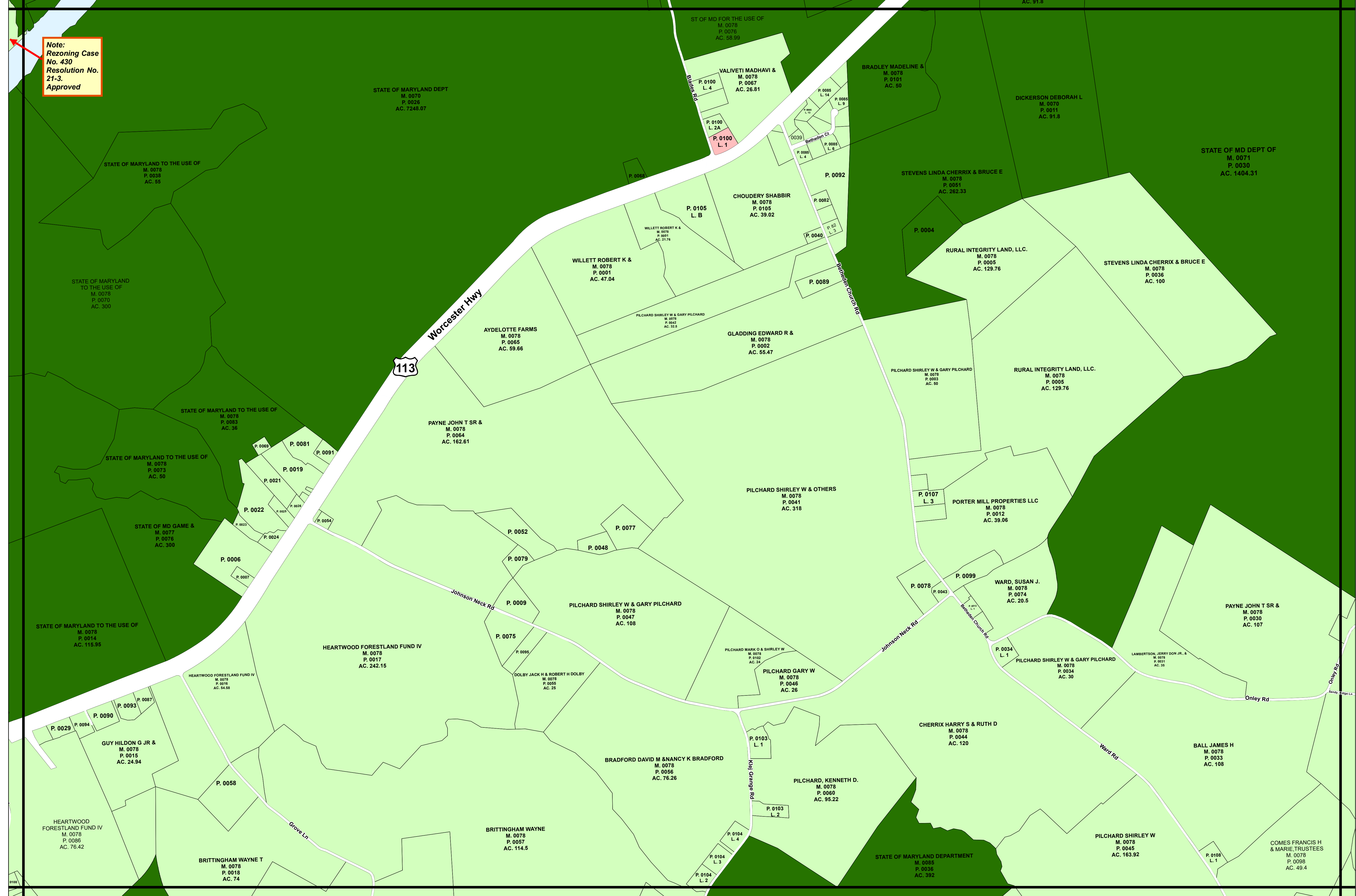

Official Zoning Map

A1	RP	R2	I1	C1	V1
A2	E1	R3	I2	C2	MUN
CA	R1	R4	CM	C3	

Map prepared by Worcester County Department of Development Review and Permitting, November 3, 2009.
Source: Worcester County Commissioners.
Updated: Resolution No. 21 - 3, Effective 06/01/21, Case No. 430.

Tax Map 78

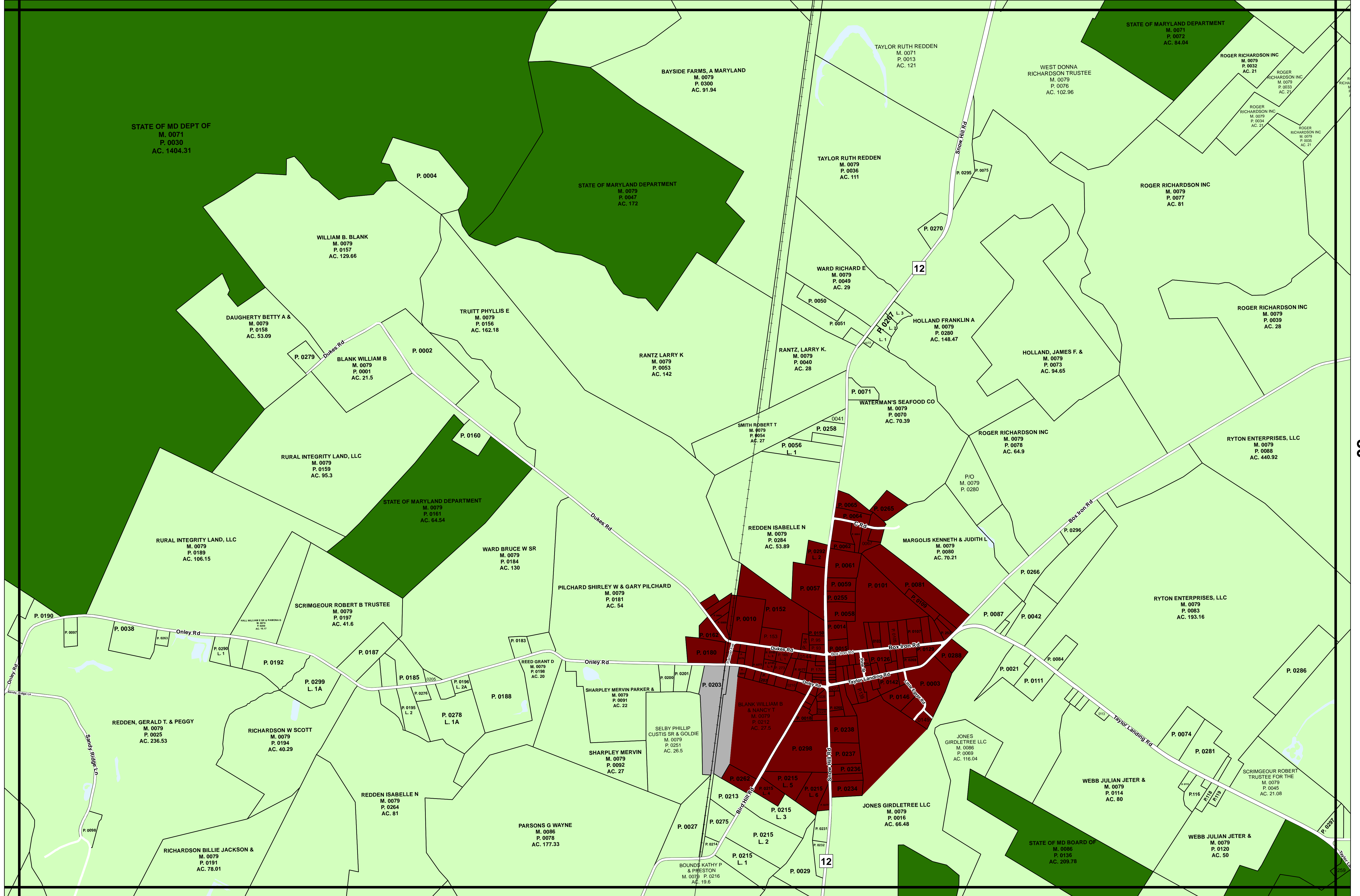

Official Zoning Map

Map prepared by Worcester County Department of Development Review and Permitting, November 3, 2009.
Source: Worcester County Commissioners.

Tax Map 79

71

72

73

79

81

86

87

88

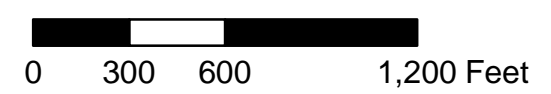
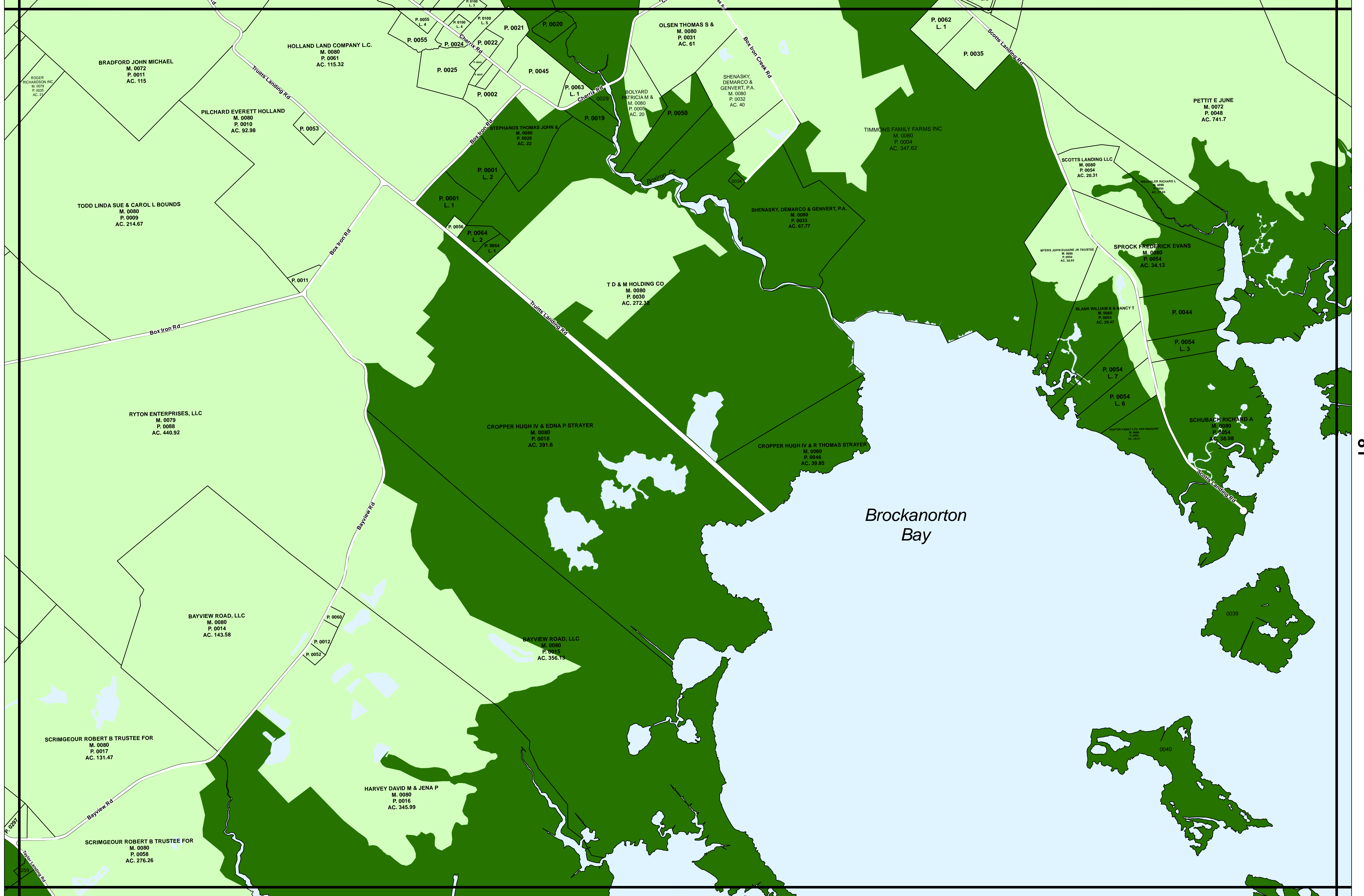

Official Zoning Map

Map prepared by Worcester County Department of Development Review and Permitting, November 3, 2009.
 Source: Worcester County Commissioners.

	A1		RP		R2		I1		C1		V1
	A2		E1		R3		I2		C2		MUN
	CA		R1		R4		CM		C3		

Tax Map 80